

IMMOBILE - F. 96, P.IIa 5921, Sub. 4  
VIA VITTIME CIVILI N. 68

Sup. lorda mq. 84,31  
Ripostiglio mq. 0,90  
Balconi mq. 9,30

pianta piano primo  
h. mt. 3.70

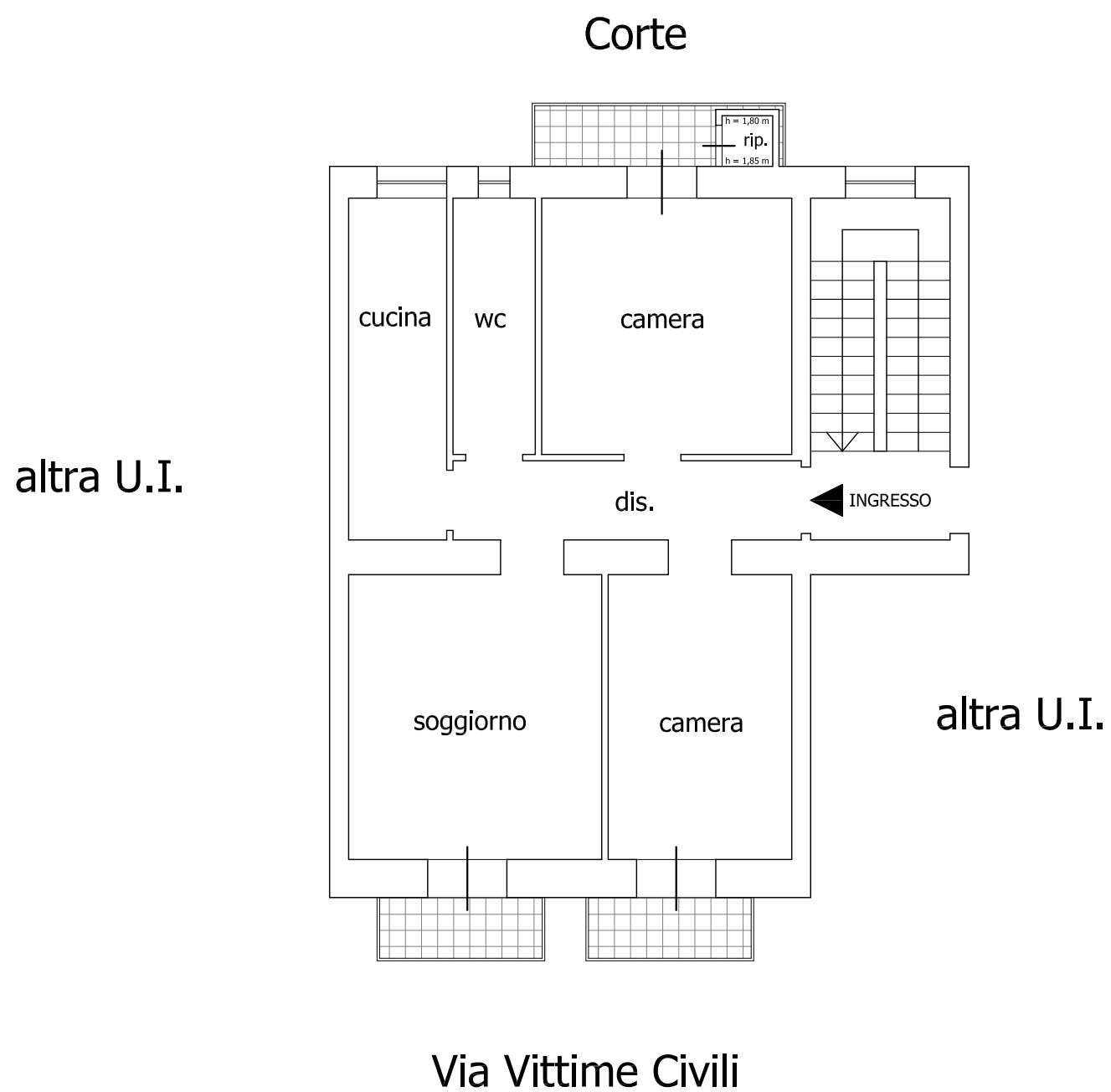

pianta piano seminterrato  
h. mt. 1.90

Sup. lorda mq. 14,00

