

Agenzia delle Entrate
CATASTO FABBRICATI
 Ufficio provinciale di
 Vicenza

Dichiarazione protocollo n. V/0163119 del 03/10/2024
 Comune di Valdagno - Novale
 Via Giovanni Soster

civ. SNC

Identificativi Catastali:
 Sezione: 11
 Foglio: 1457
 Particella: 1457
 Subalterno: 37

Compilata da:
 Di Nuovo Antonella
 Iscritto all'albo:
 Geometri
 Provv. Vicenza N. 1816

Planimetria
 Scheda 1: 200

Ultima planimetria in atti

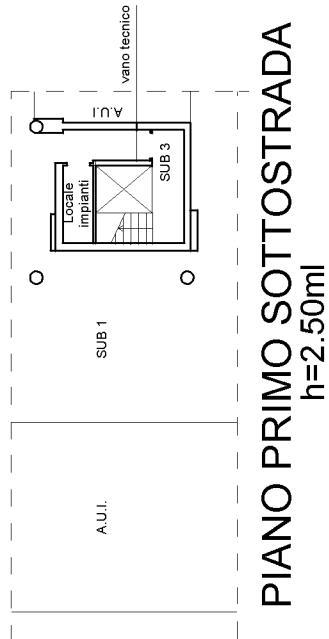

PIANO PRIMO SOTTOSTRADA
 h=2.50m

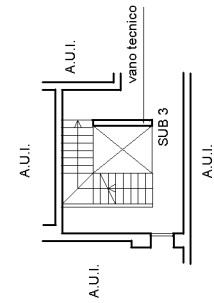

PIANO TERRA
 h=2.70m

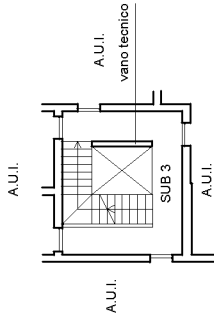

PIANO PRIMO
 h=2.70m

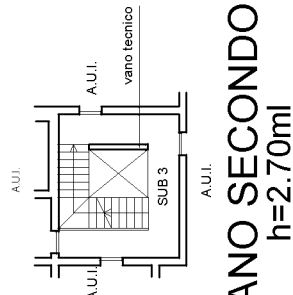

PIANO SECONDO
 h=2.70m

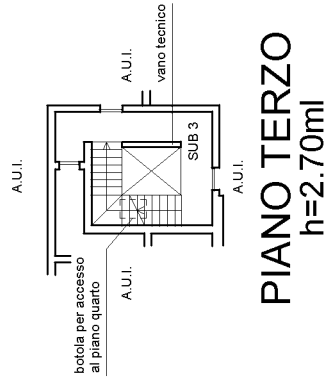

PIANO TERZO
 h=2.70m

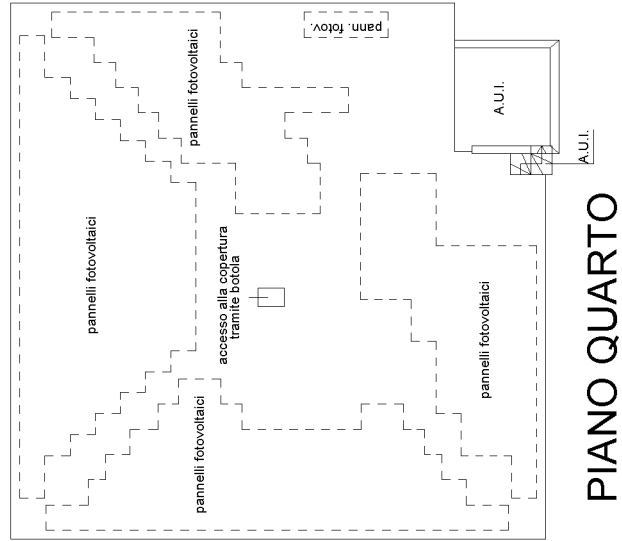

PIANO QUARTO

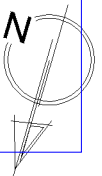

**Agenzia del Territorio
CATASTO FABBRICATI
Ufficio Provinciale di
Vicenza**

Dichiarazione protocollo n. VI0127217 del 03/06/2013

Planimetria di u.i.u. in Comune di Valdagno - Novale

Via Giovanni Soster

civ.

Identificativi Catastali:

Sezione:
Foglio: 11
Particella: 1484
Subalterno: 4

Compilata da:
Preto Paolo Michele
Iscritto all'albo:
Geometri

Prov. Vicenza

N. 2476

Scheda n. 1

Scala 1:200

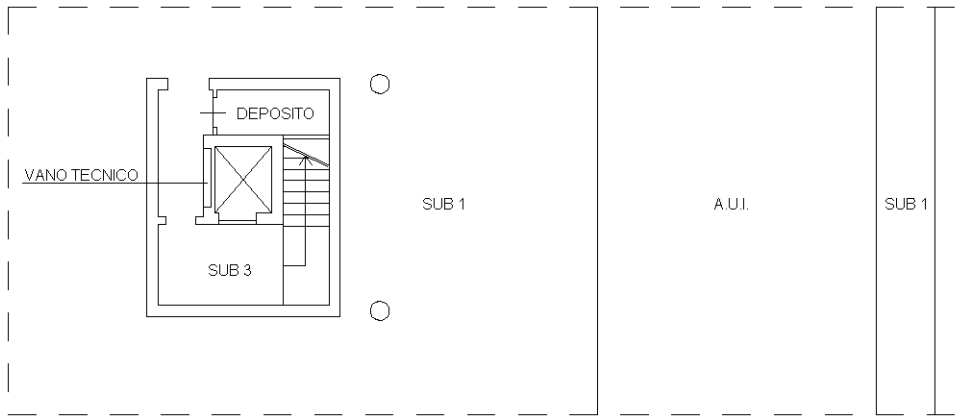

PIANO INTERRATO
H=2.40ml

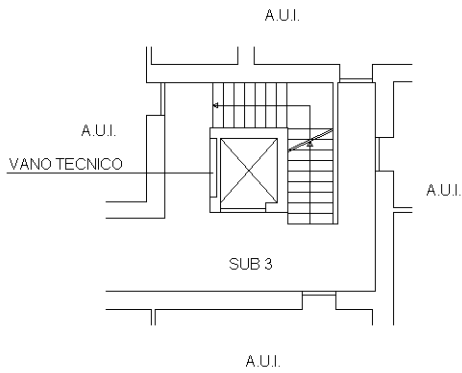

PIANO TERRA
H=2.70ml

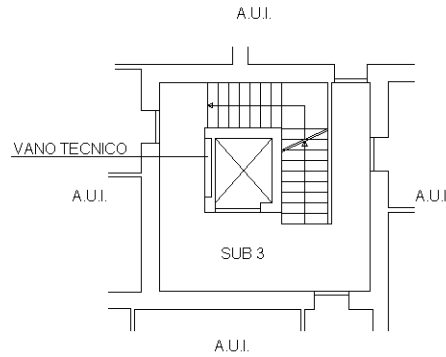

PIANO PRIMO
H=2.70ml

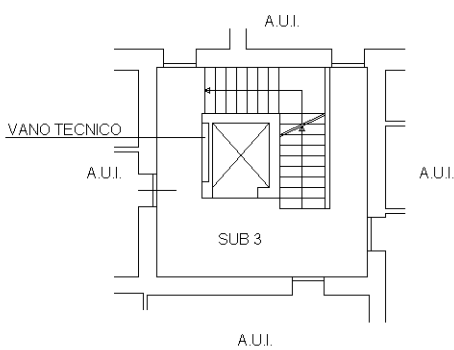

PIANO SECONDO
H=2.70ml

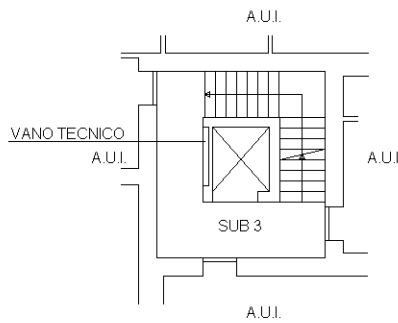

PIANO TERZO
H=2.70ml

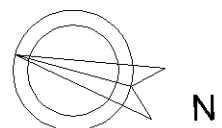

Ultima planimetria in atti

**Agenzia delle Entrate
CATASTO FABBRICATI
Ufficio Provinciale di
Vicenza**

Dichiarazione protocollo n. VI0020635 del 20/02/2015

Planimetria di u.i.u. in Comune di Valdagno - Novale

Viale Duca D' Aosta

civ. SNC

Identificativi Catastali:

Sezione:

Foglio: 11

Particella: 1485

Subalterno: 4

Compilata da:

Preto Paolo Michele

Iscritto all'albo:

Geometri

Prov. Vicenza

N. 2476

Scheda n. 1

Scala 1:200

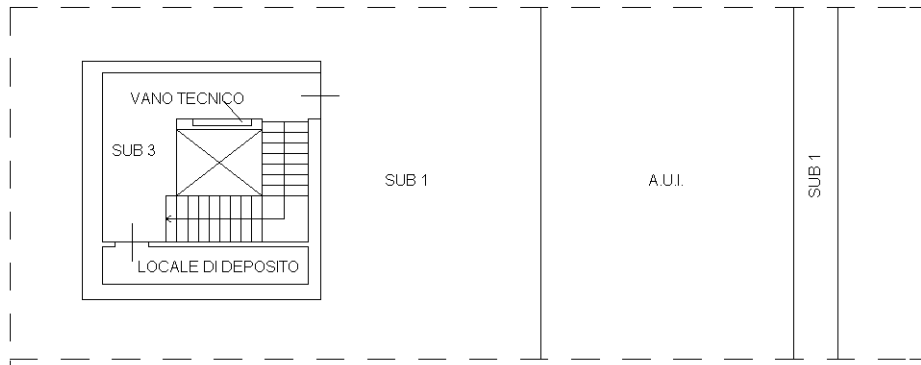

PIANO INTERRATO

H=2.40ml

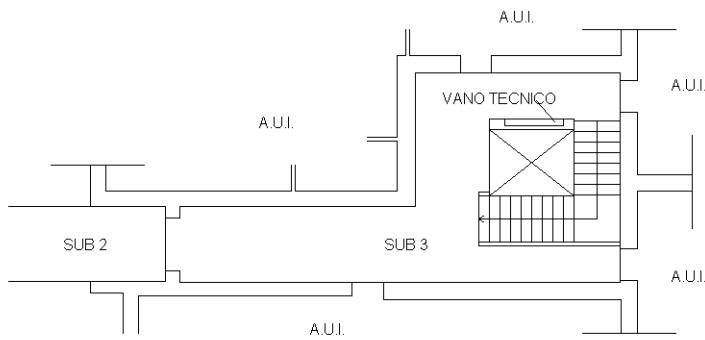

PIANO TERRA

H=2.70ml

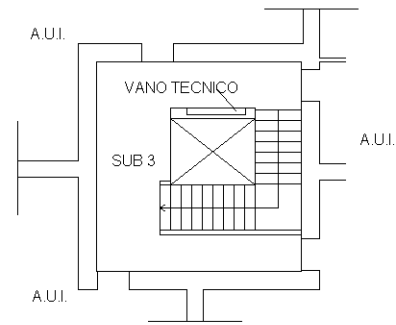

PIANO PRIMO

H=2.70ml

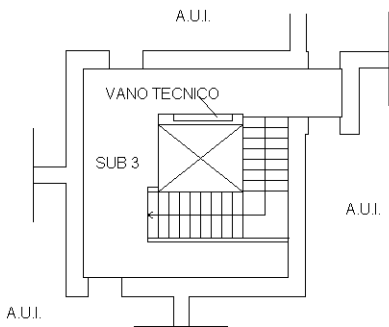

PIANO SECONDO

H=2.70ml

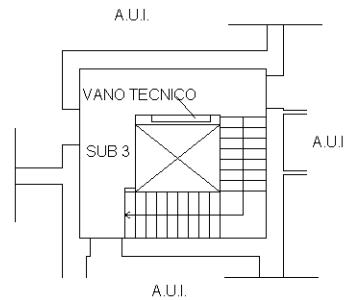

PIANO TERZO

H=2.70ml

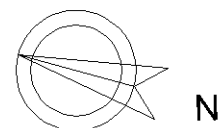

Ultima planimetria in atti