

LOTTO N.3 PROC. ES. R.G.81.20
TRIBUNALE DI TERMINI IMERESE

IMMOBILE SITO IN CASTRONOVO DI SICILIA
C/da Vallone della Fiera snc, edificio D
piano QUARTO (LOCALE DEPOSITO)
Fg.46, part.1116, sub.11.

Hmax= ml. 1.80 hmin= ml.0.60

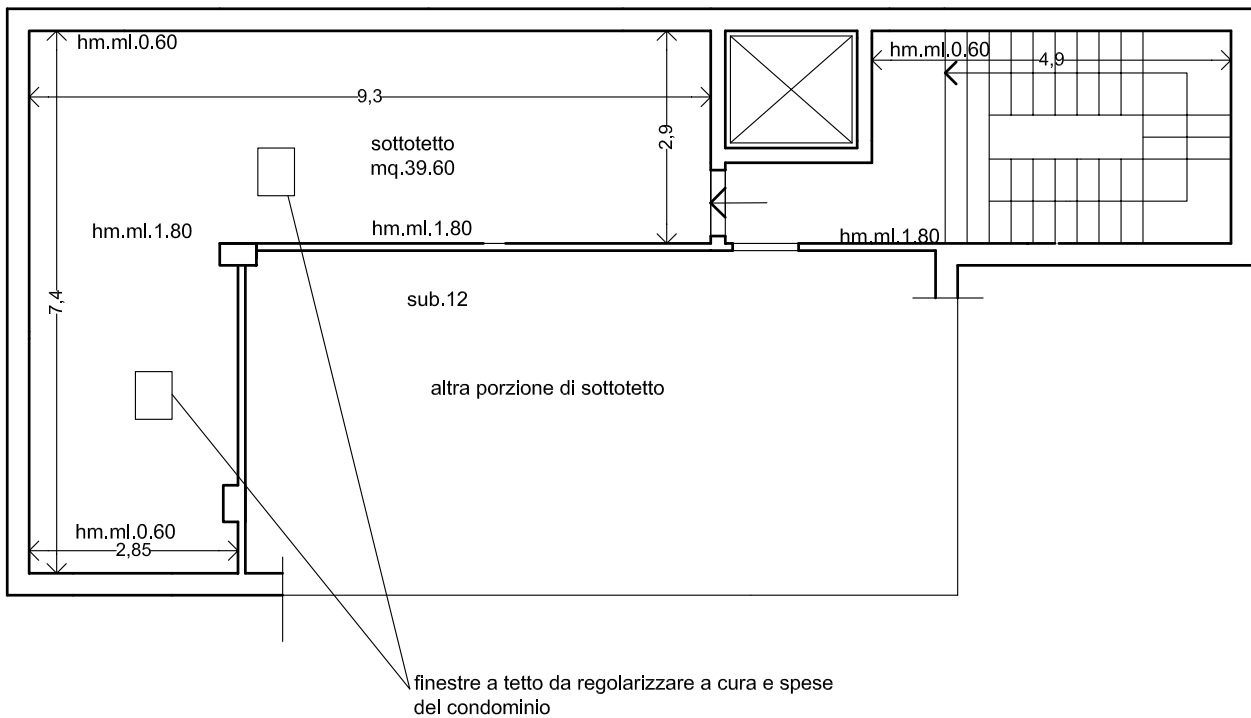

Sup.comm. : mq.46.00 (SUP.COPERTA) *0,40=
= mq.18.40
Sup. netta mq.39.60
sup.scoperta mq.0



SCALA 1:100

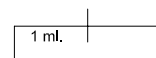

Rilievo dimensionale dello stato attuale
Esperto stimatore: dott.arch. Maria Pia Clelia Valenza