

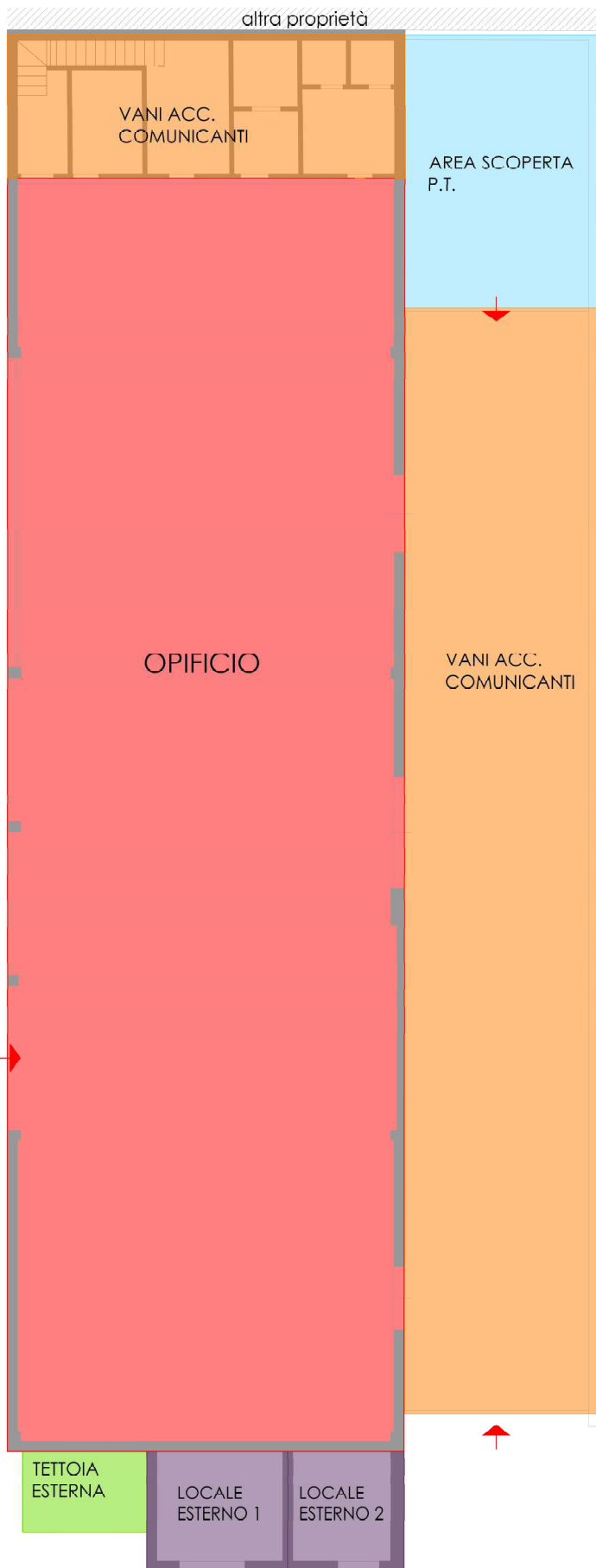

PIANO AMMEZZATO - Scala 1:100

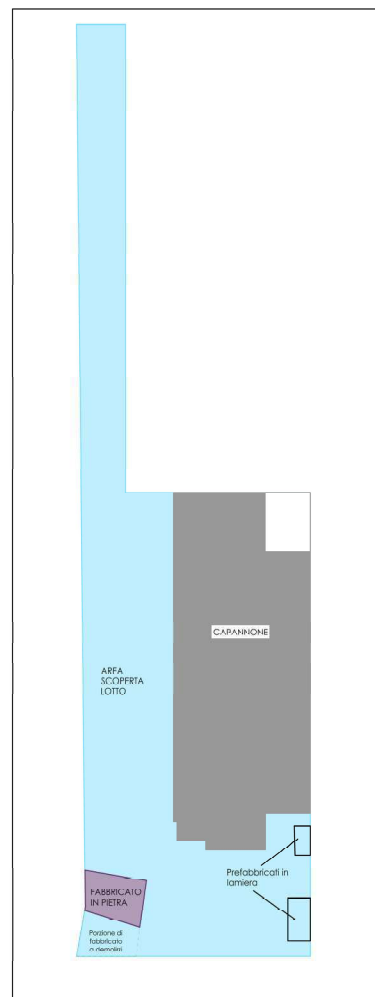

PIANO TERRA - Scala 1:100



AREA ESTERNA - Scala 1: 2000

- VANI PRINCIPALI
- VANI ACCESSORI DIRETTI COMUNICANTI (50%)
- VANI ACCESSORI INDIRETTI NON COMUNICANTI (25%)
- AREE SCOPERTE (11,7%)
- PERTINENZE ESCLUSIVE DI ORNAMENTO (balconi e tettoia)

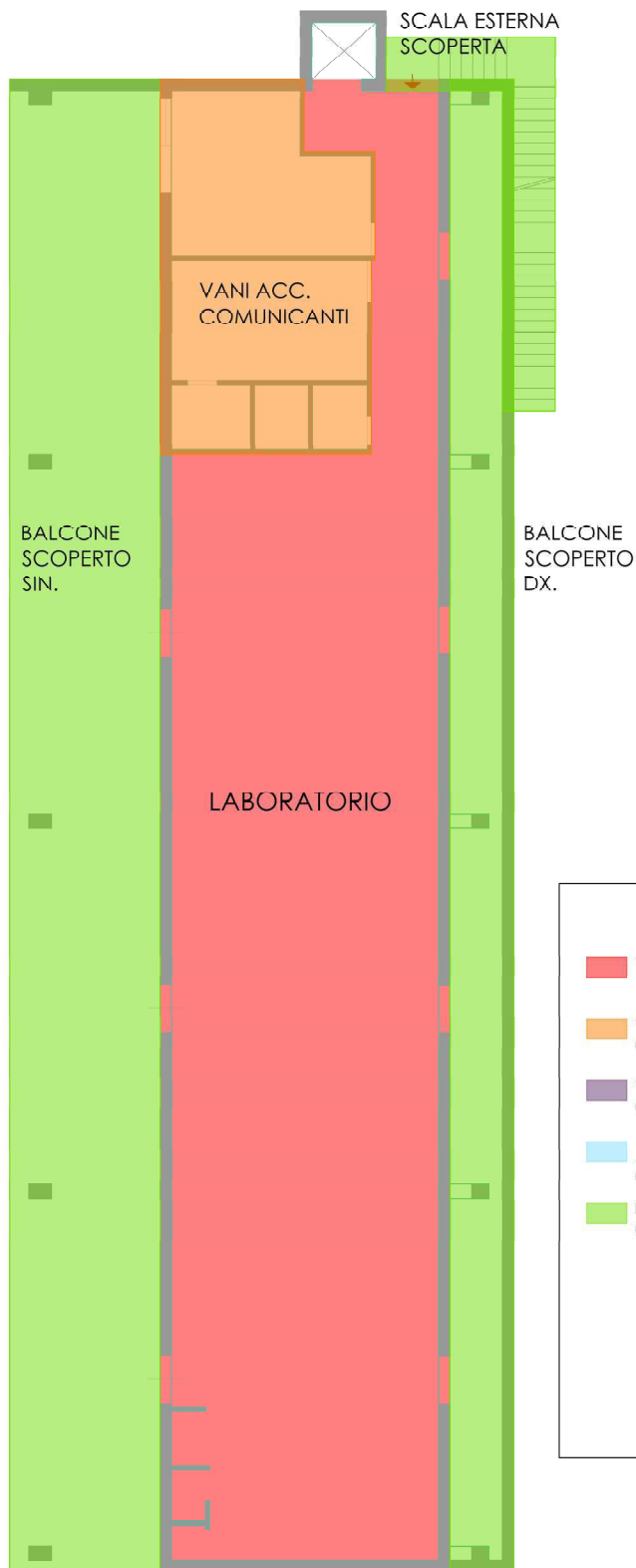

PIANO PRIMO - Scala 1:100