

- ALLEGATO 3 -
ELABORATO GRAFICO

Arch. Vincenzo Gandolfo
Via Felice Cavallotti, 8 - 91026 Mazara del Vallo (TP)
Tel. 3281223028
E-mail arch.vincenzogandolfo@gmail.com
PEC vincenzo.gandolfo@archiworldpec.it

ESECUZIONE IMMOBILIARE n° 122/2025 R.G.E.I.
ALL RESERVED S.R.L. contro Regina Anna Maria





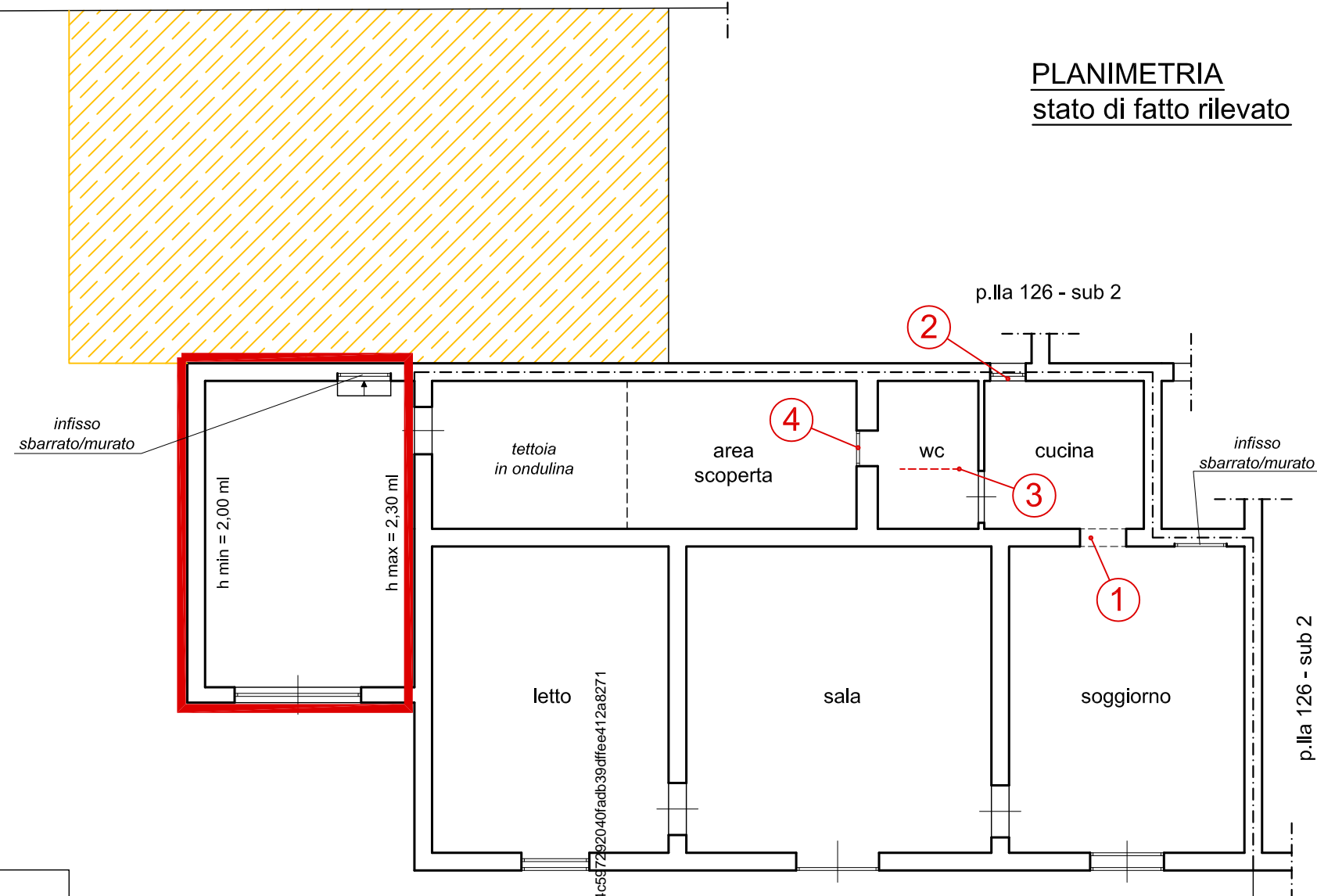



PLANIMETRIA
stato di fatto rilevato



Firmato Da: VINCENZO GANDOLFO Emesso Da: ARUBAPEC EU QUALIFIED CERTIFICATES CA G1 Serial#: 354c597292040fad39dfee412a8271

DIFFORMITA' RISCOstrate
(su base documentazione urbanistica e/o catastale acquisita)

-  area pertinenziale occupata da ampliamento della p.lla 126 - sub 2
-  locale abusivo
-  apertura vano traslata rispetto agli elaborati urbanistici e catastali
-  dimensione infisso non conforme alle norme igienico-sanitarie e agli elaborati urbanistici
-  assenza divisorio anti-wc come indicato negli elaborati urbanistici e catastali
-  dimensione infisso non conforme alle norme igienico-sanitarie e agli elaborati urbanistici

strada comunale c.da S. Anna

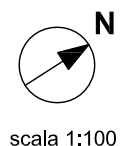

scala 1:100