

ALLEGATO 2

(Documentazione Fotografica)

appartamento
sito in Terni - Via Narni 99/E
(fg. 103 - part. 473 sub. 6)

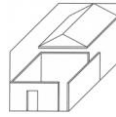



ripresa dalla Via Narni

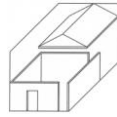

ripresa laterale/retro fabbricato

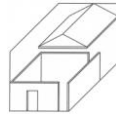

ripresa retro fabbricato

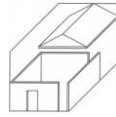

interno appartamento piano primo

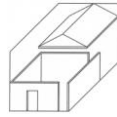

interno appartamento piano primo

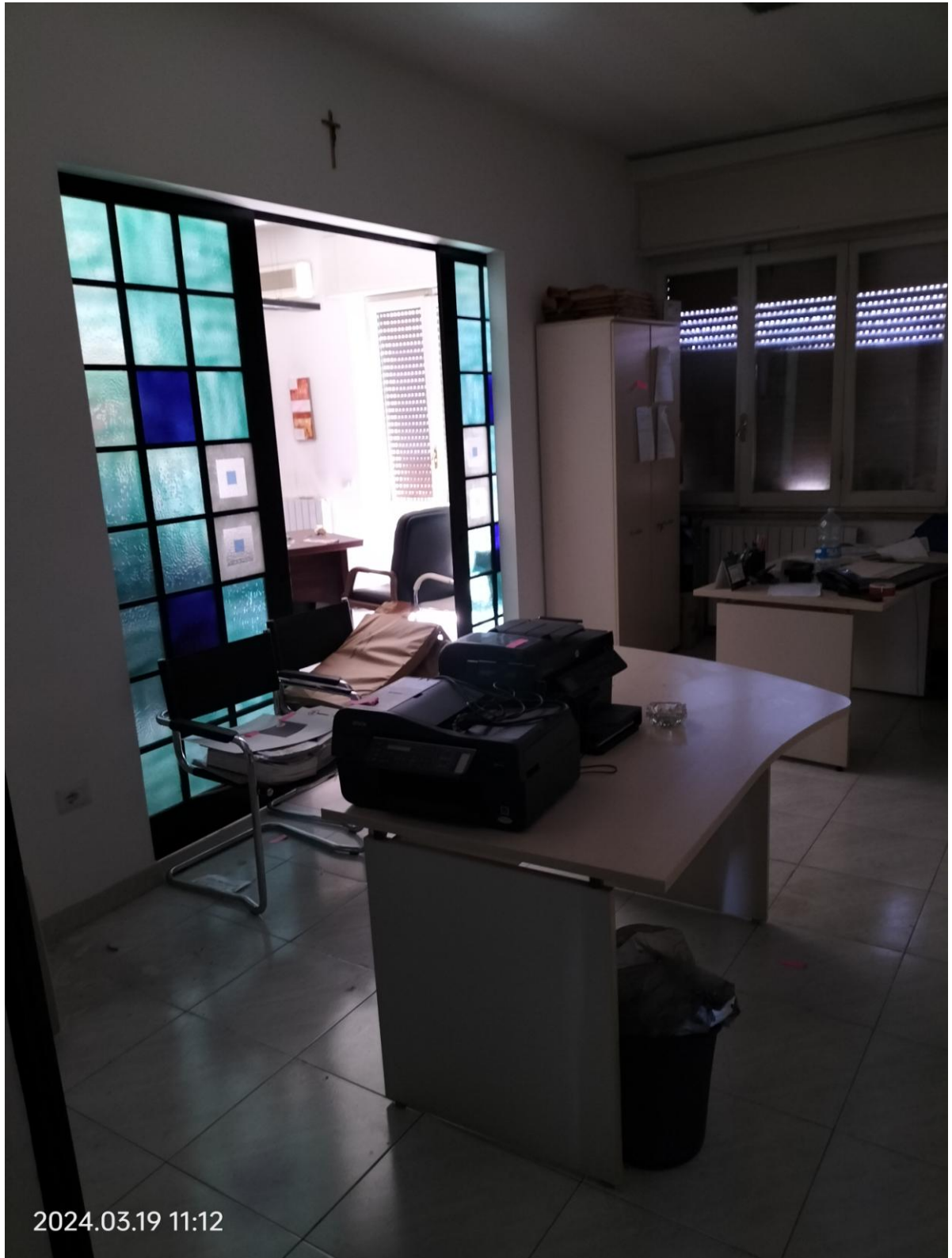
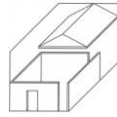

interno appartamento piano primo

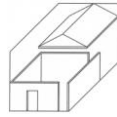

interno appartamento piano primo

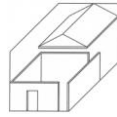

interno appartamento piano primo

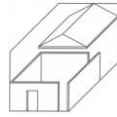

interno appartamento piano primo (bagno)

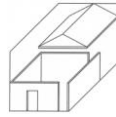

ripresa esterna cantina piano terra, con porta di accesso al cortile sul retro del fabbricato, appartenente ad altra ditta (non interessato dalla procedura)

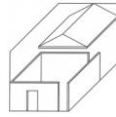

porzione di copertura della cantina (in eternit) sottostante al terrazzo del piano primo

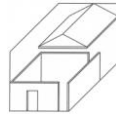

accesso locale cantina al piano terra dal vano scala comune

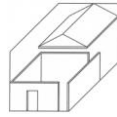

interno locale cantina piano terra