

PROCEDURA ESECUTIVA IMMOBILIARE R.G.E. N°313/2016

FINDOMESTIC BANCA S.P.A. C/O

TAVOLA N°1

Dati Catastali: Comune di Lentini
N.C.E.U. foglio 78, part.989, sub1
via Tolmino n°4

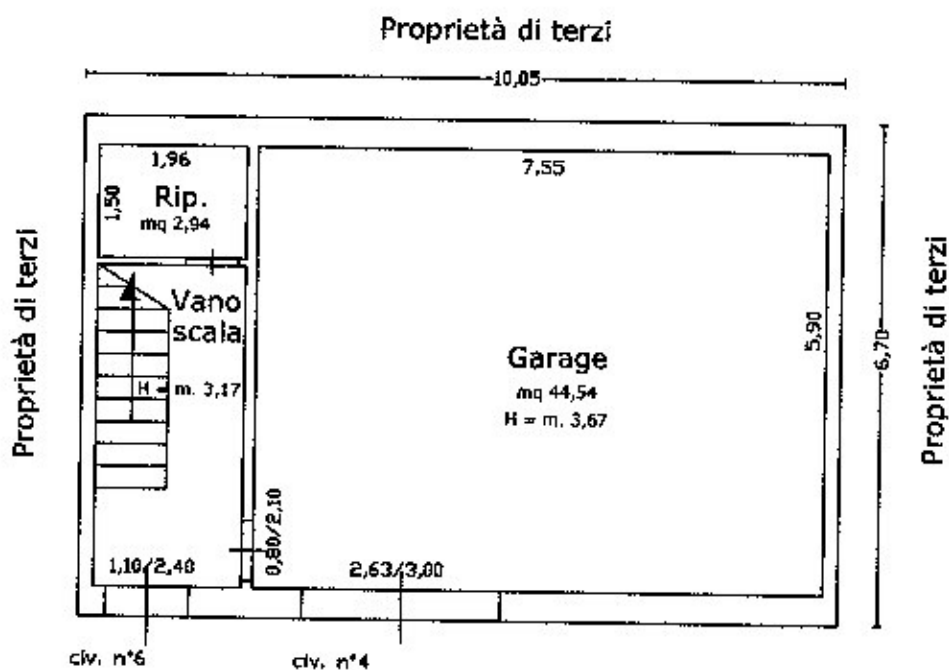
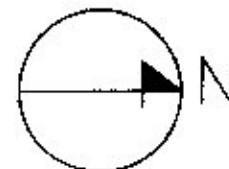

Via Tolmino

PIANO TERRA

Superficie netta
Garage Mq 44,54
h = m. 3,67

SUPERFICIE LORDA COMMERCIALE MQ 50,29

SCALA 1:100

Dott.  

FINDOMESTIC BANCA S.P.A. C/O

TAVOLA N°2

Dati Catastali: Comune di Lentini
N.C.E.U. foglio 78, part.989, sub6
via Tolmino n°6

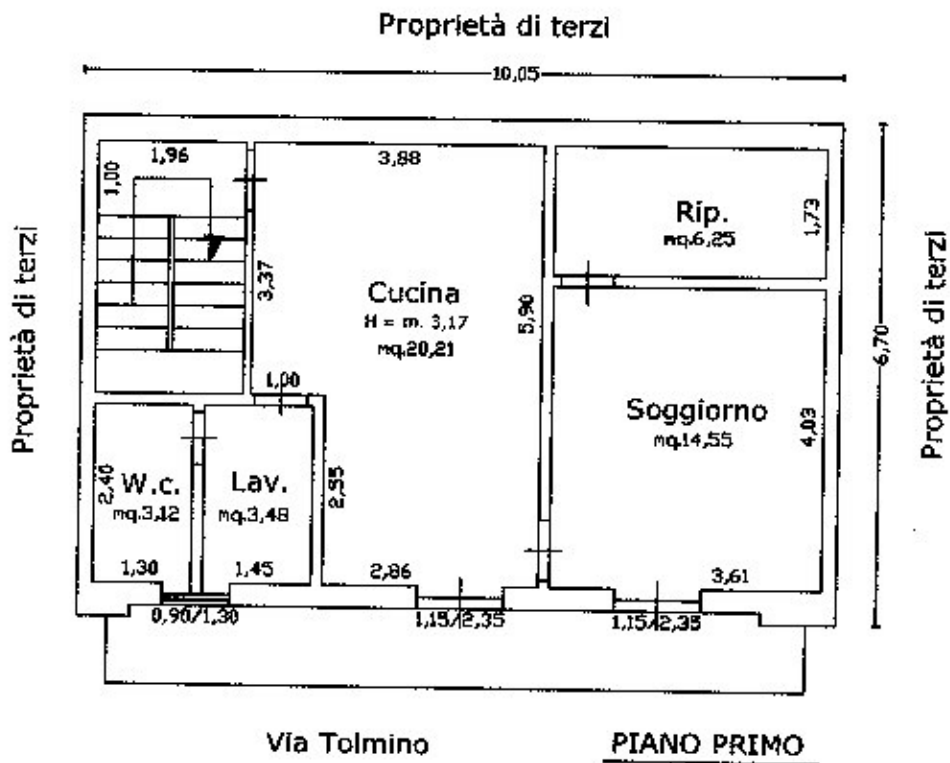
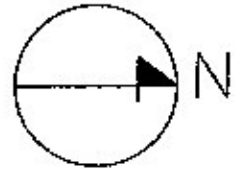

Superficie netta
Piano primo Mq 47,61
h = m. 3,17

SUPERFICIE LORDA COMMERCIALE MQ 55,31

SCALA 1:100

Dott. Ingeg. Antonio...

Dati Catastali: Comune di Lentini
N.C.E.U. foglio 78, part.989, sub6
via Tolmino n°6

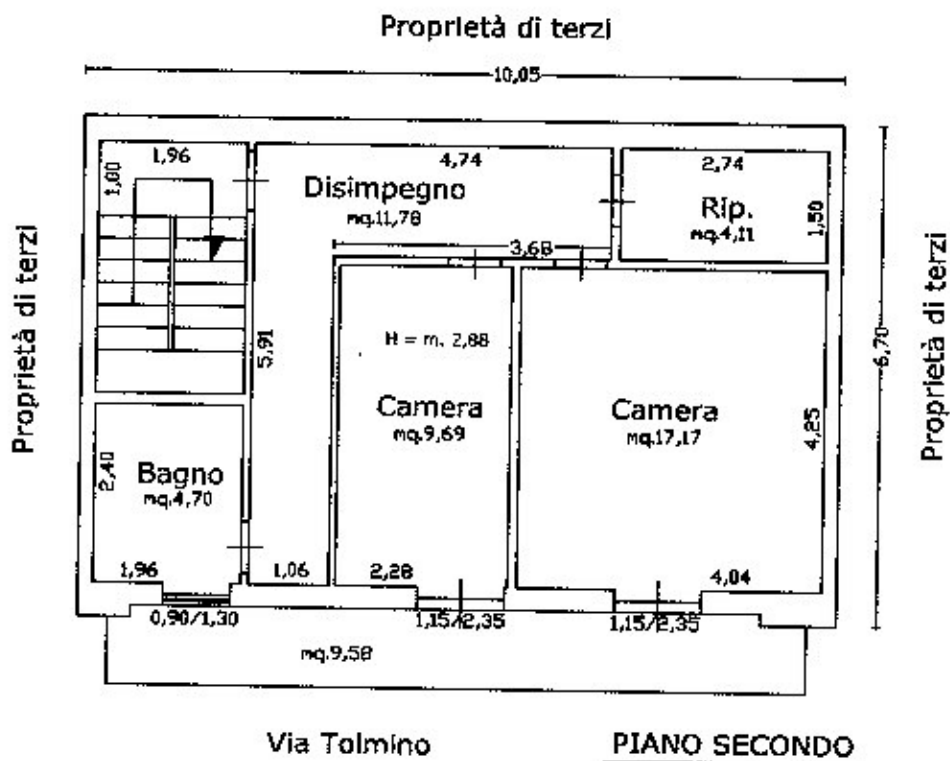
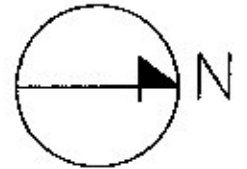

Superficie netta
Piano secondo Mq 47,61
h = m. 2,88

SUPERFICIE LORDA COMMERCIALE MQ 55,31

SCALA 1:100

Dott. Ingegnere  *[Signature]*

FINDOMESTIC BANCA S.P.A. C/O

TAVOLA N°4

Dati Catastali: Comune di Lentini
N.C.E.U. foglio 78, part.989, sub6
via Tolmino n°6

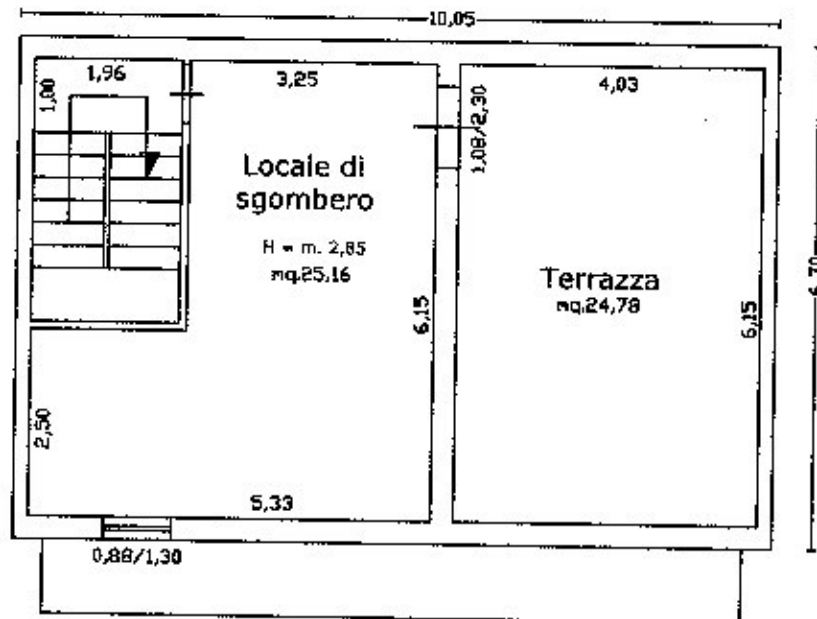
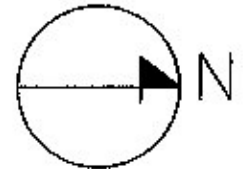

Via Tolmino

PIANO TERZO

Superficie netta
Piano terzo Mq 25,16
h = m. 2,85
Terrazza Mq 24,78

SCALA 1:100

SUPERFICIE LORDA COMMERCIALE MQ 29,80

SUPERFICIE LORDA COMMERCIALE COMPLESSIVA ABITAZIONE MQ 143,36

Dott. Ingegnere *[Signature]*