

ALLEGATO 2

(Documentazione Fotografica)

Lotto 001

immobile ad uso ricettivo e ricreativo
(ristorante e sala da ballo)
sito in Otricoli (TR) - Via Roma snc
(ex Strada dell'Ortera snc)

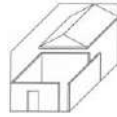

esterno fabbricato - lato sud (dal parcheggio pubblico)

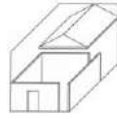

esterno fabbricato - lato sud (dal parcheggio pubblico)

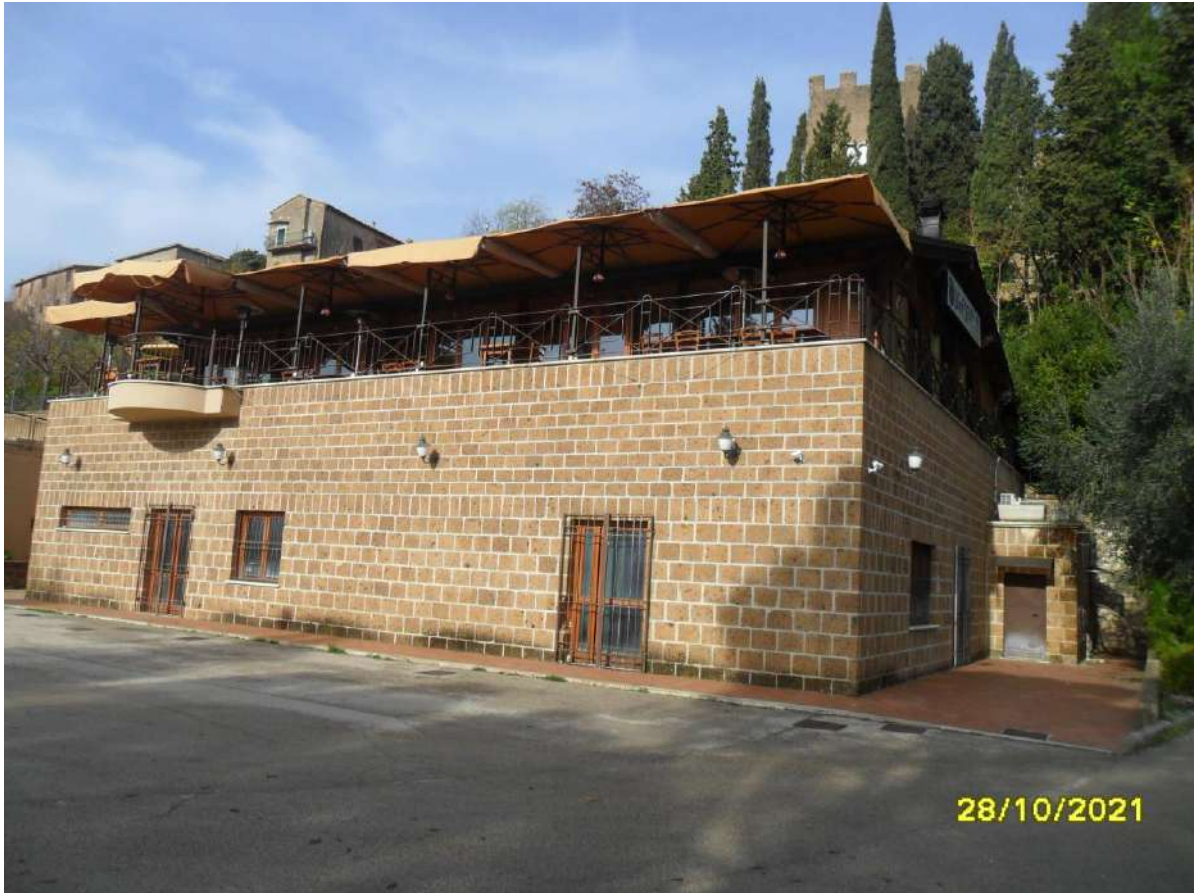
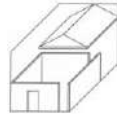

esterno fabbricato - lato sud (dal parcheggio pubblico)

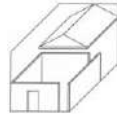

esterno fabbricato - lato est (dalla strada di accesso)

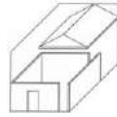

esterno fabbricato - lato ovest (accesso superiore dalla strada dell' Ortera)

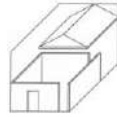

interno piano terra (locale "sala da ballo" sub. 4)

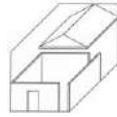

interno piano terra (locale "sala da ballo" sub. 4)

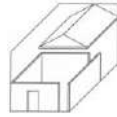

interno piano terra (locale "sala da ballo" sub. 4)

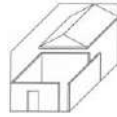

interno piano terra (locale accessorio del ristorante/pub "frigoriferi-dispensa" sub. 5)

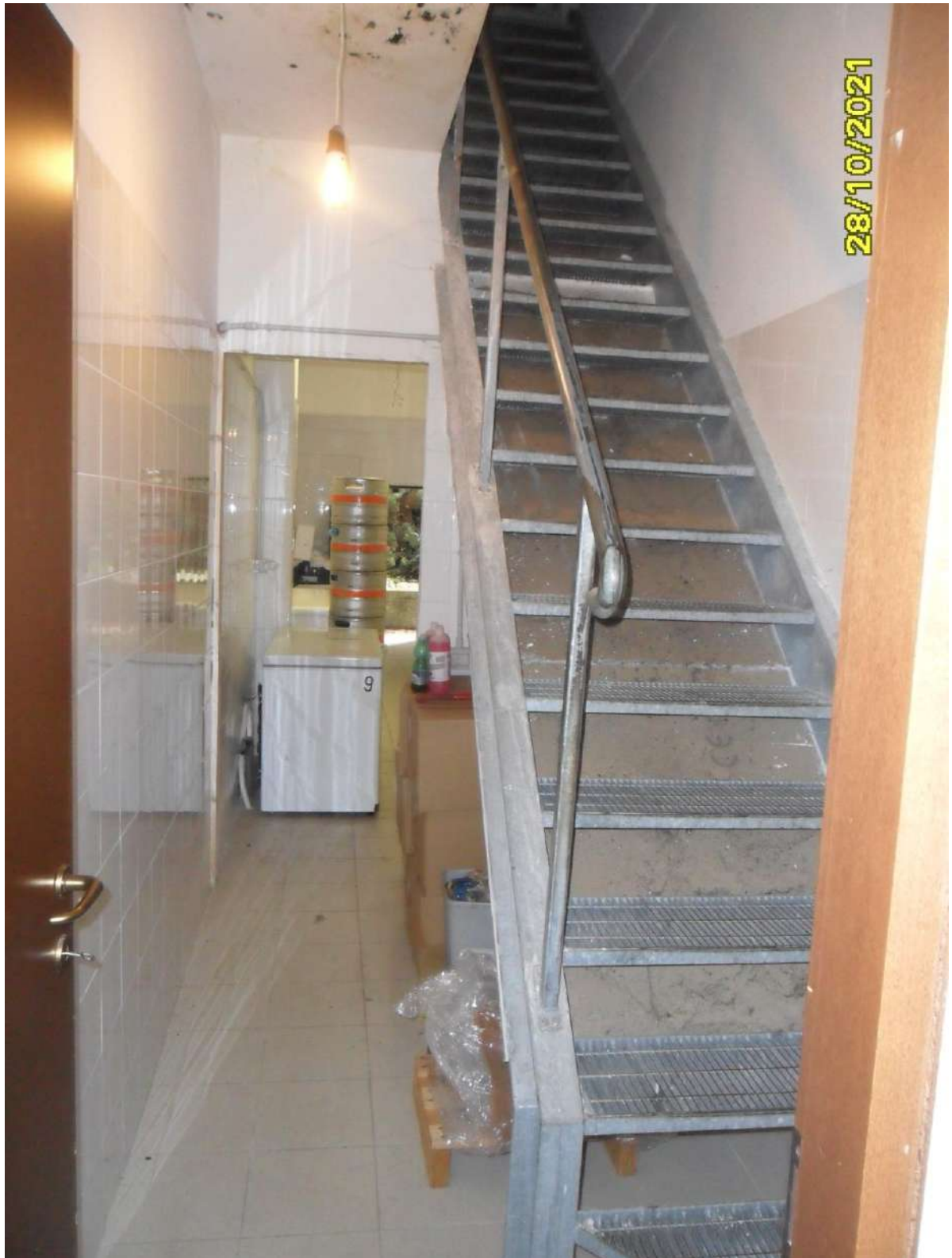
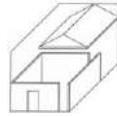

interno piano terra (disimpegno/scala di servizio ristorante/pub sub. 5)

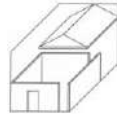

interno piano terra (spogliatoio e w.c. ristorante/pub sub. 5)

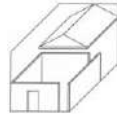

piano primo (terrazzo ristorante/pub sub. 5)

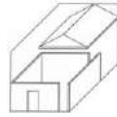

piano primo (terrazzo ristorante/pub sub. 5)

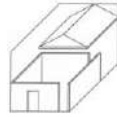

piano primo (ingresso ristorante/pub sub. 5)

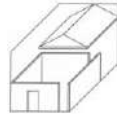

piano primo (ristorante/pub sub. 5)

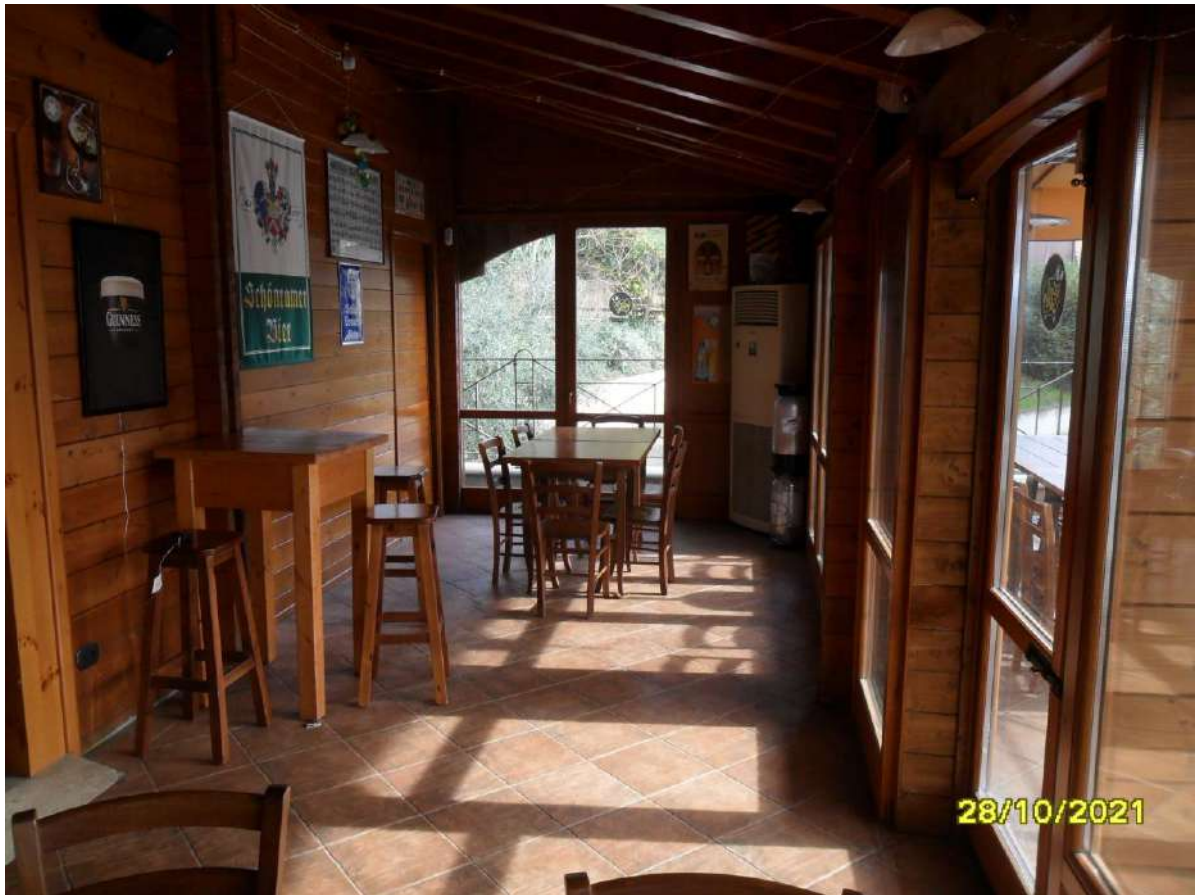
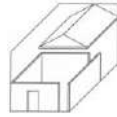

piano primo (portico chiuso ristorante/pub sub. 5)

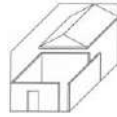

piano primo (ristorante/pub sub. 5)

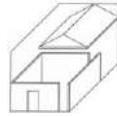

piano primo (w.c. ristorante/pub sub. 5)

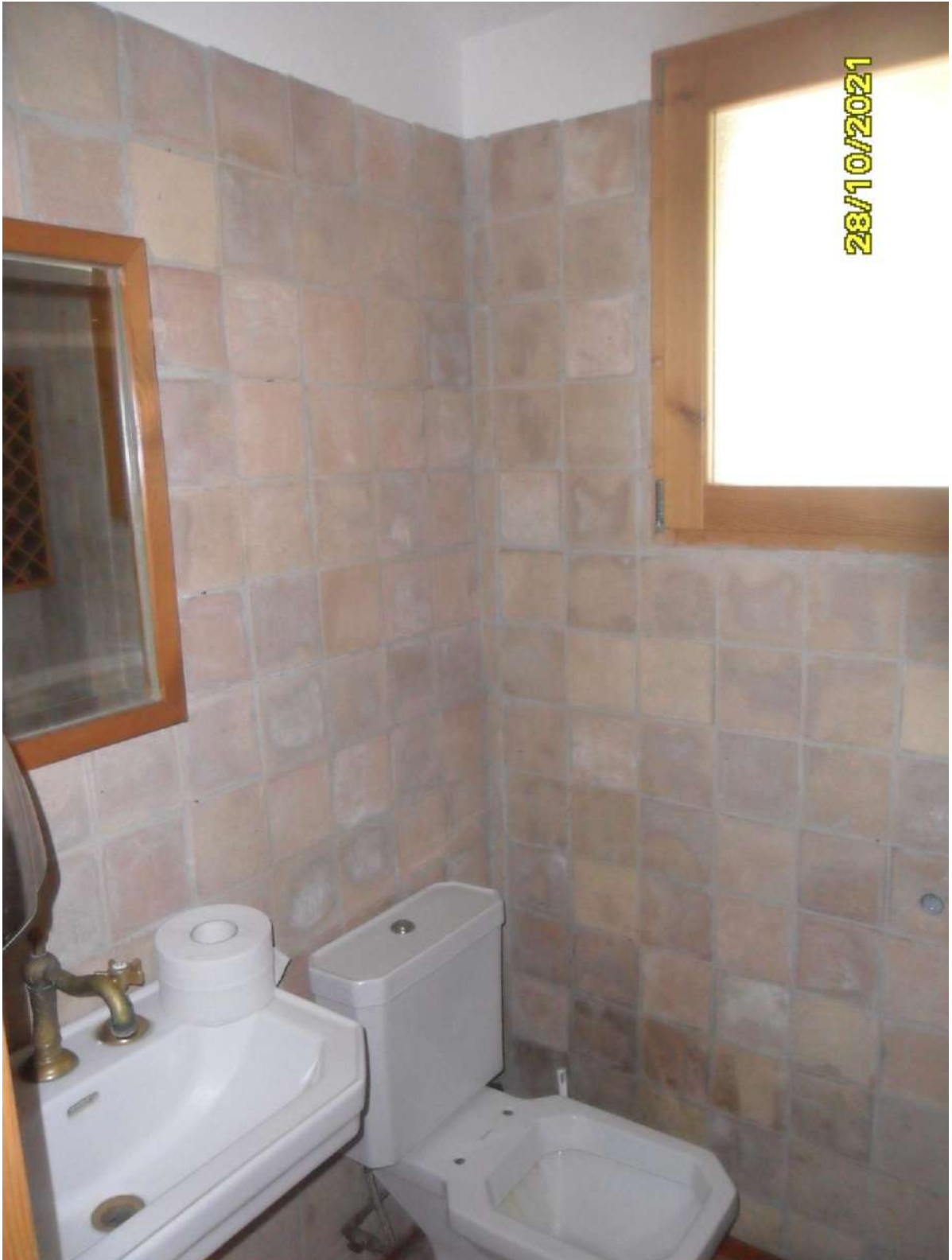
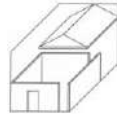

piano primo (w.c. ristorante/pub sub. 5)

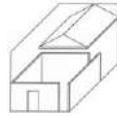

piano primo (zona braciere ristorante/pub sub. 5)

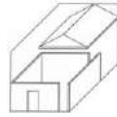

piano primo (cucina ristorante/pub sub. 5)

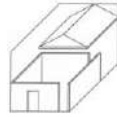

piano primo: ampliamento dispensa retro-cucina
(realizzato in difformità rispetto a quanto assentito con il titolo edilizio)

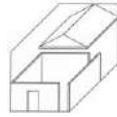

piano primo: ampliamento dispensa retro-cucina
(realizzato in difformità rispetto a quanto assentito con il titolo edilizio)

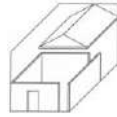

piano primo (terrazzo retrostante al ristorante/pub sub. 5)

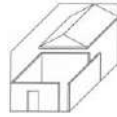

piano terra (vano tecnico - bene comune non censibile sub. 6)