

**ABITAZIONE PIANO TERRA**  
 SUP. LORDA ABITAZIONE = 251,00 mq  
 SUP. NETTA ABITAZIONE = 213,60 mq  
 SUP. NETTA TAVERNA = 30,40 mq  
 SUP. LORDA TAVERNA = 35,40 mq  
 SUP. PORTICO = 13,40 mq

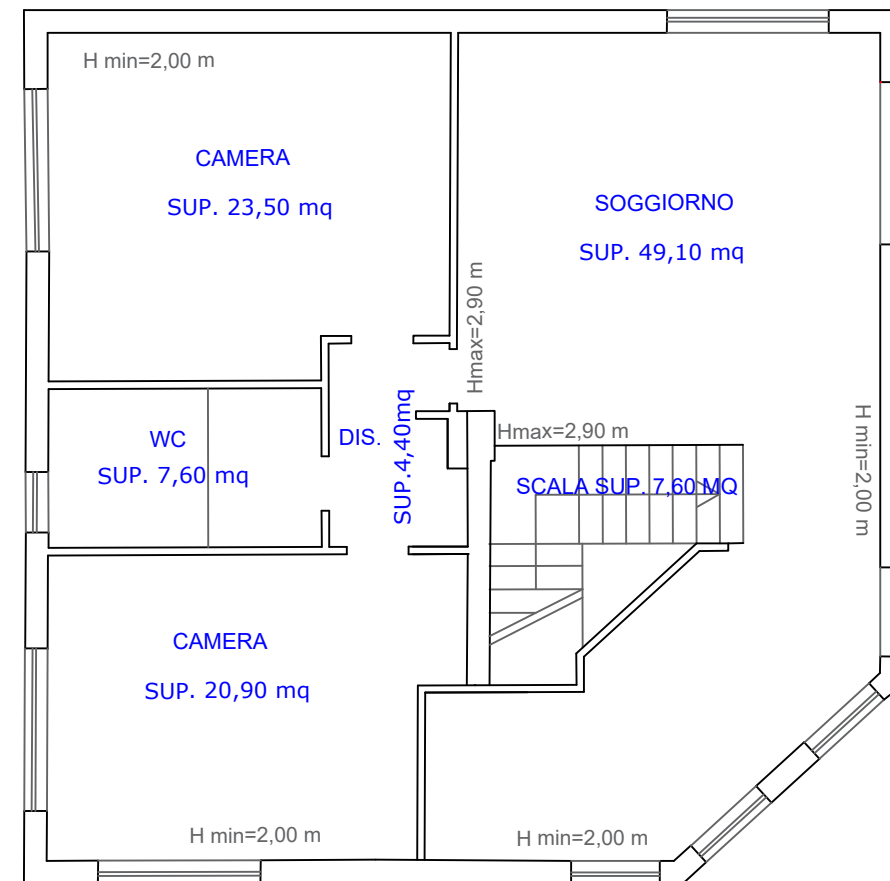

**ABITAZIONE PIANO I°**  
 SUP. LORDA = 130,50 mq  
 SUP. NETTA = 105,50 mq  
 SUP. LORDA SCALA 7,60 mq

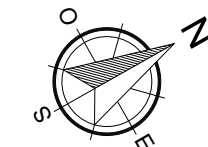

**PIANO TERRA**  
(hm=2,70ml)