

# PIANTA PIANO PRIMO

H= mt. 2.85 (stato di fatto) scala 1:100  
 foglio 162, p.lla 944, sub. 7

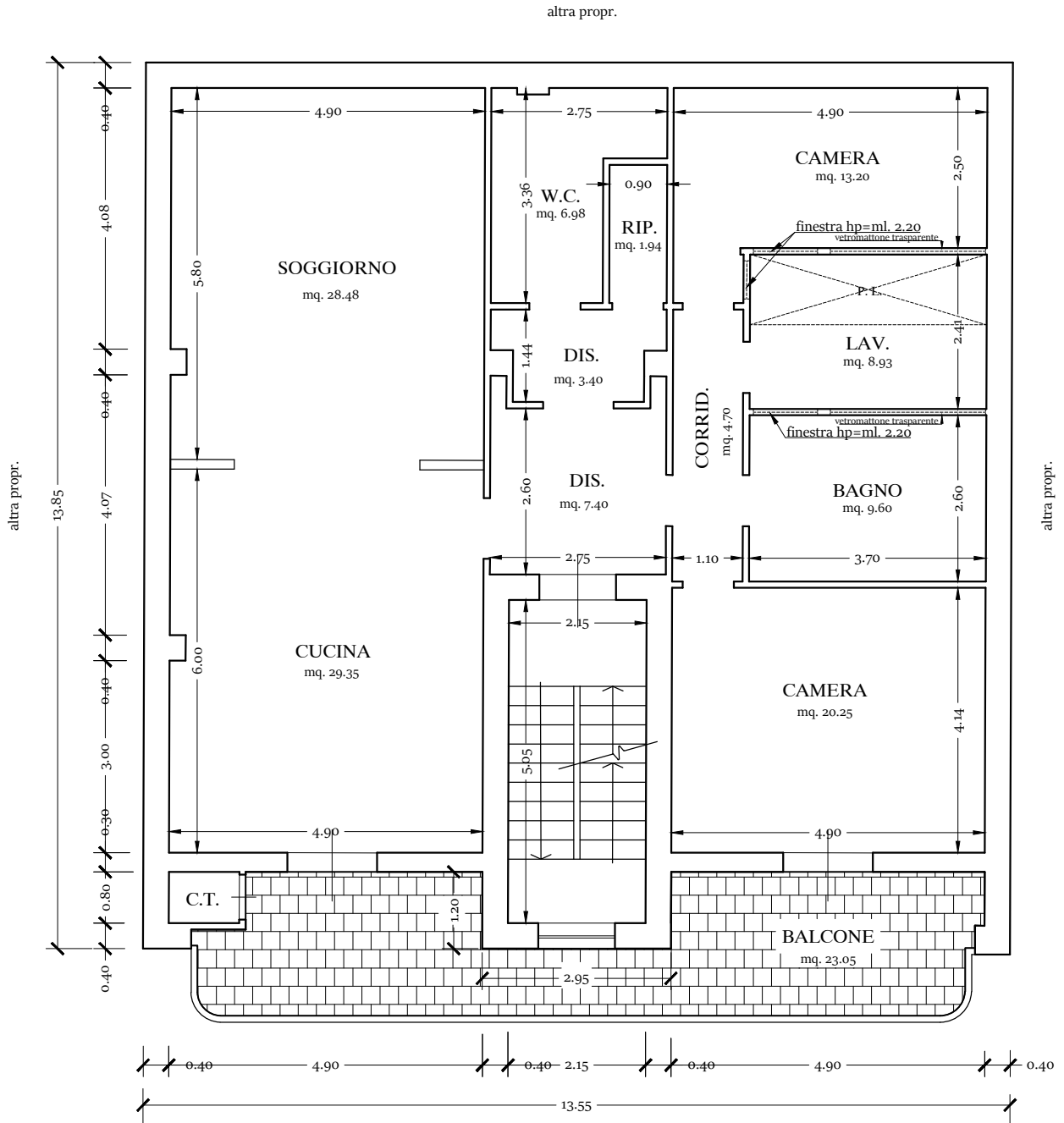

Viale Maria S.S. Ausiliatrice



# PIANTA PIANO SECONDO

H= mt. 2.85 (stato di fatto) scala 1:100  
foglio 162, p.lla 944, sub. 8

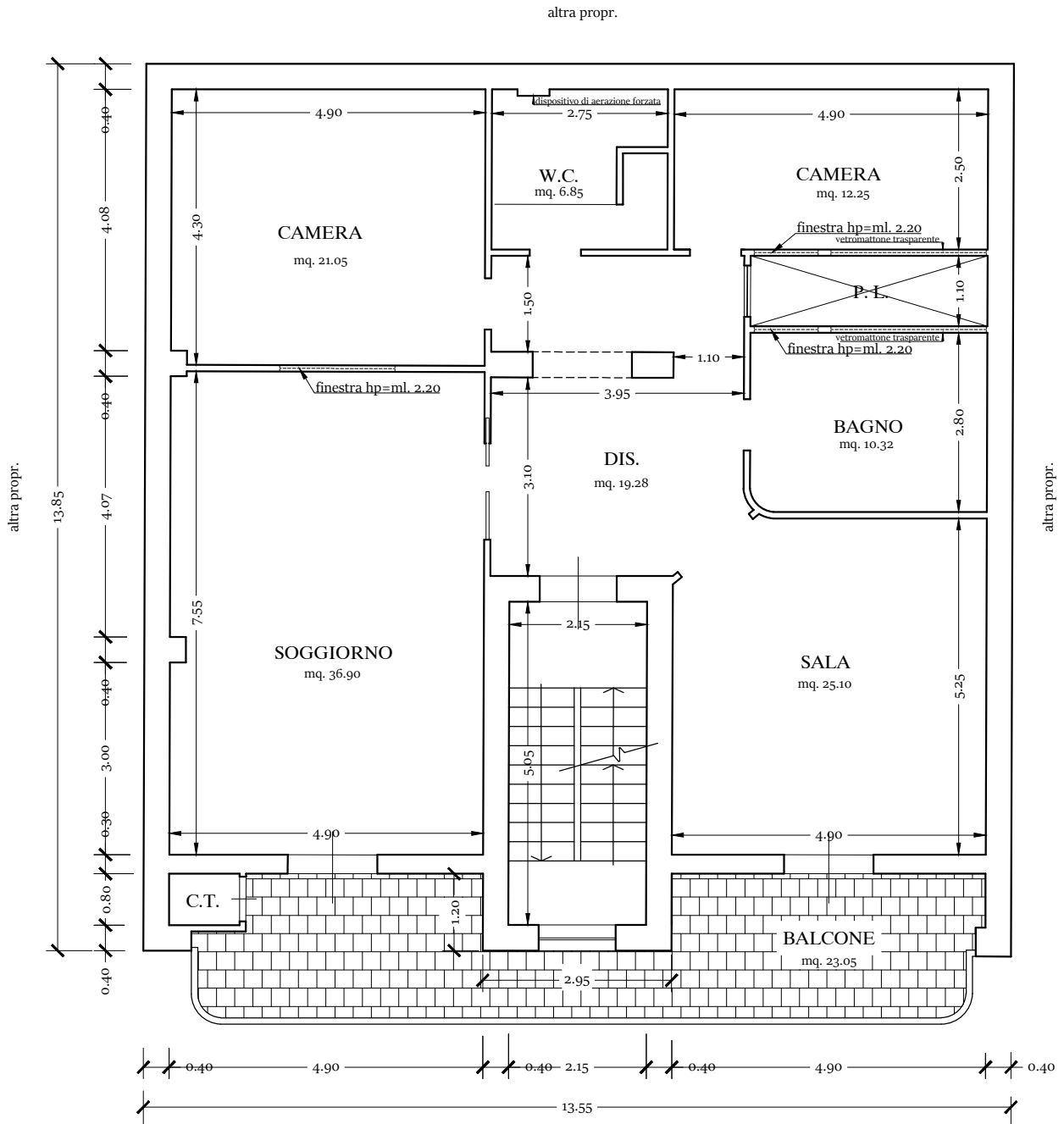

Viale Maria S.S. Ausiliatrice



# PIANTA PIANO TERZO

H= mt. 2.50 (stato di fatto) scala 1:100  
foglio 162, p.lla 944, sub. 10

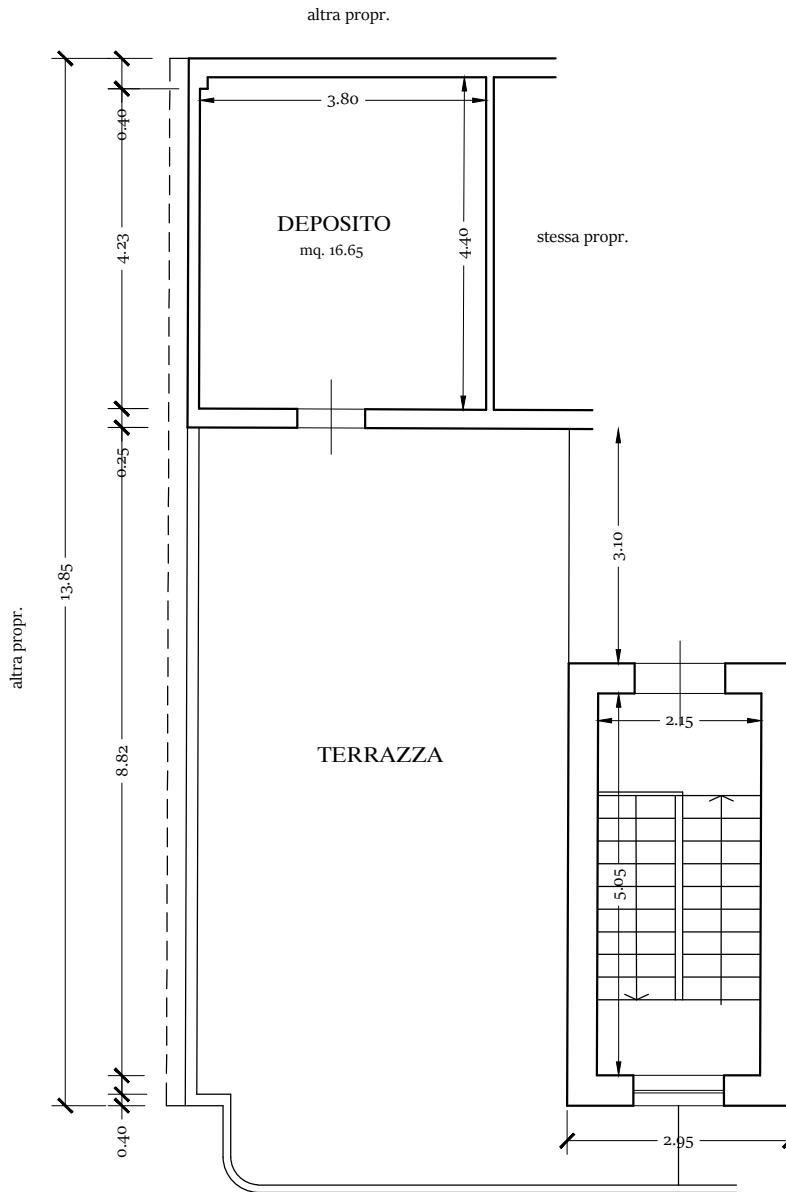

Viale Maria S.S. Ausiliatrice



# PIANTA PIANO TERZO

H= mt. 2.50 (stato di fatto) scala 1:100  
foglio 162, p.lla 944, sub. 11

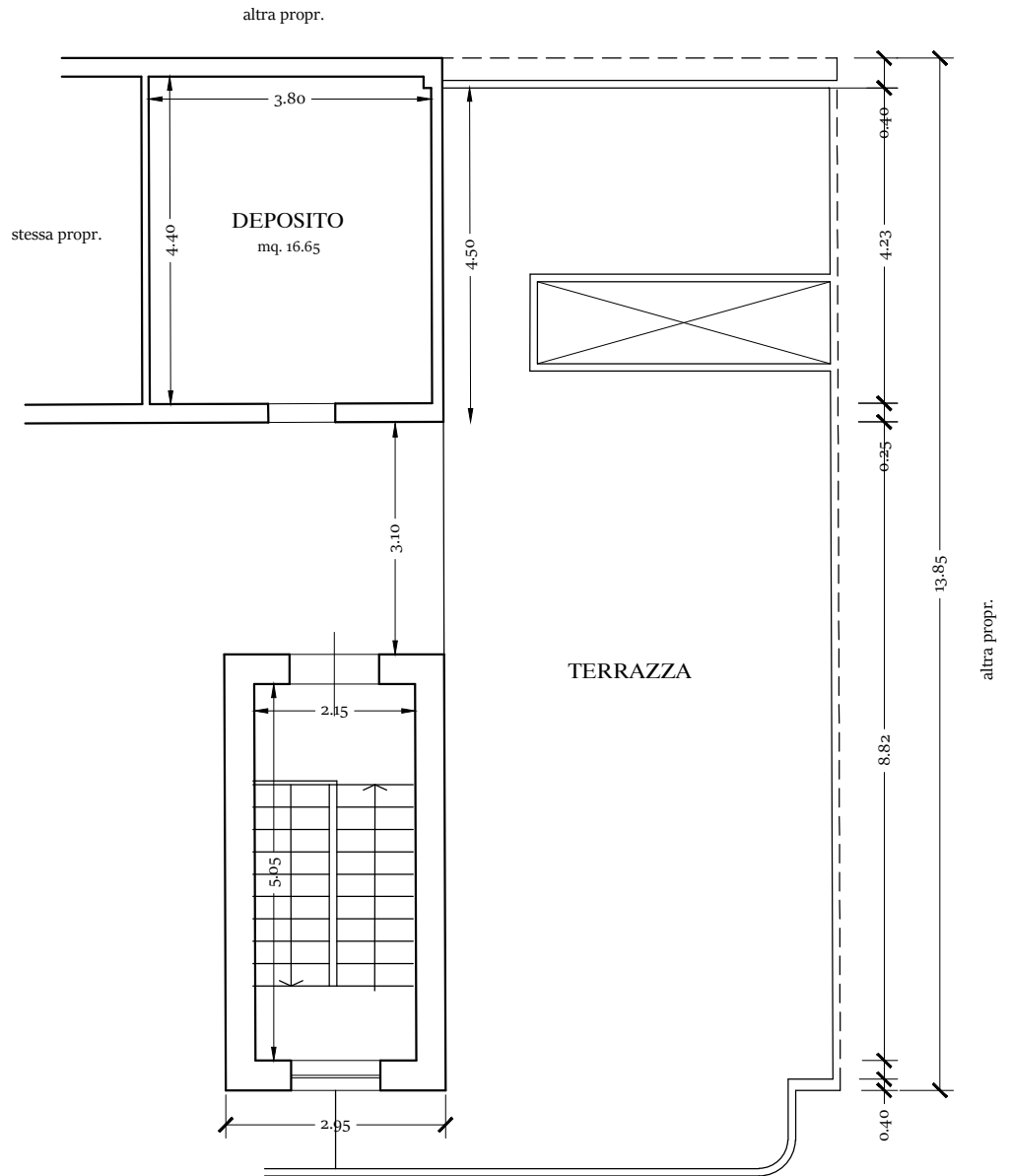





Viale Maria S.S. Ausiliatrice





# Azzonamento



## Legenda

### Zone omogenee



-  A1 - Centro antico
-  A2 - Prima espansione del centro antico
-  A3<sup>1</sup> - Espansione ottocentesca
-  A3<sup>2</sup> - Espansione ottocentesca
-  B1<sup>1</sup> - Primo ampliamento urbano



-  B1<sup>2</sup> - Primo ampliamento urbano



-  B2 ru - Riassetto urbano
-  B2 tu - Trasformazione urbanistica ed edilizia
-  B3<sup>1</sup> - Recente formazione
-  B3<sup>1</sup> - Recente formazione  
Valgono le norme ed i parametri del progetto n.99/309 del 5.10.99 agli Atti Comunali

-  B3<sup>2</sup> - Recente formazione
-  B3<sup>3</sup> - Recente formazione

-  B4 - Recente formazione  
difforme dalle previsioni urbanistiche precedenti

-  C1 - Espansione di iniziativa pubblica
-  Area di cessione nelle zone C1

-  C2 - Espansione di iniziativa privata
-  Area di cessione nelle zone C2

-  D1 - Industria
-  D2 - Artigianato e commercio con residenza annessa
-  D3 - Industria, artigianato e commercio

-  D4 - Mista

-  D5 - Mista

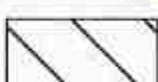
-  E - Agricola

### Servizi di interesse comunale

-  F1 - Istruzione
-  F1 - Attrezzatura di interesse comune
-  F1 - Verde attrezzato
-  F1 - Parcheggio



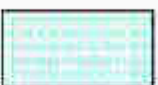
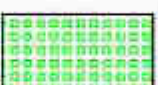

### Servizi di interesse sovracomunale

-  F2 - Istruzione
-  F2 - Attrezzatura di interesse comune
-  F2 - Verde

### Servizi privati di interesse generale

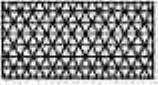
-  F3

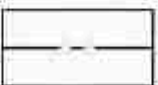
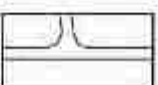
### Aree ed attrezzature per la mobilità

-  Stazione ferroviaria
-  Ferrovia di progetto
-  Ferrovia interrata di progetto
-  Viabilità esistente
-  Viabilità di progetto
-  Viabilità interrata di progetto

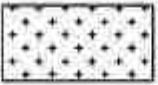

### Fasce di rispetto



-  stradale e ferroviaria
-  cimiteriale

### Perimetrazione degli strumenti attuativi

-  Piano approvato e convenzionato
-  Piano attuativo
-  Zona di recupero

### Beni immobili tutelati

-  Beni immobili soggetti al D. Lgs. 490/99 titolo I
-  Aree soggette al D. Lgs. 490/99 titolo I

-  Perimetrazione del centro edificato (D.L. n.865/1971)
-  Perimetrazione del centro abitato (D.L. n. 285/1992)



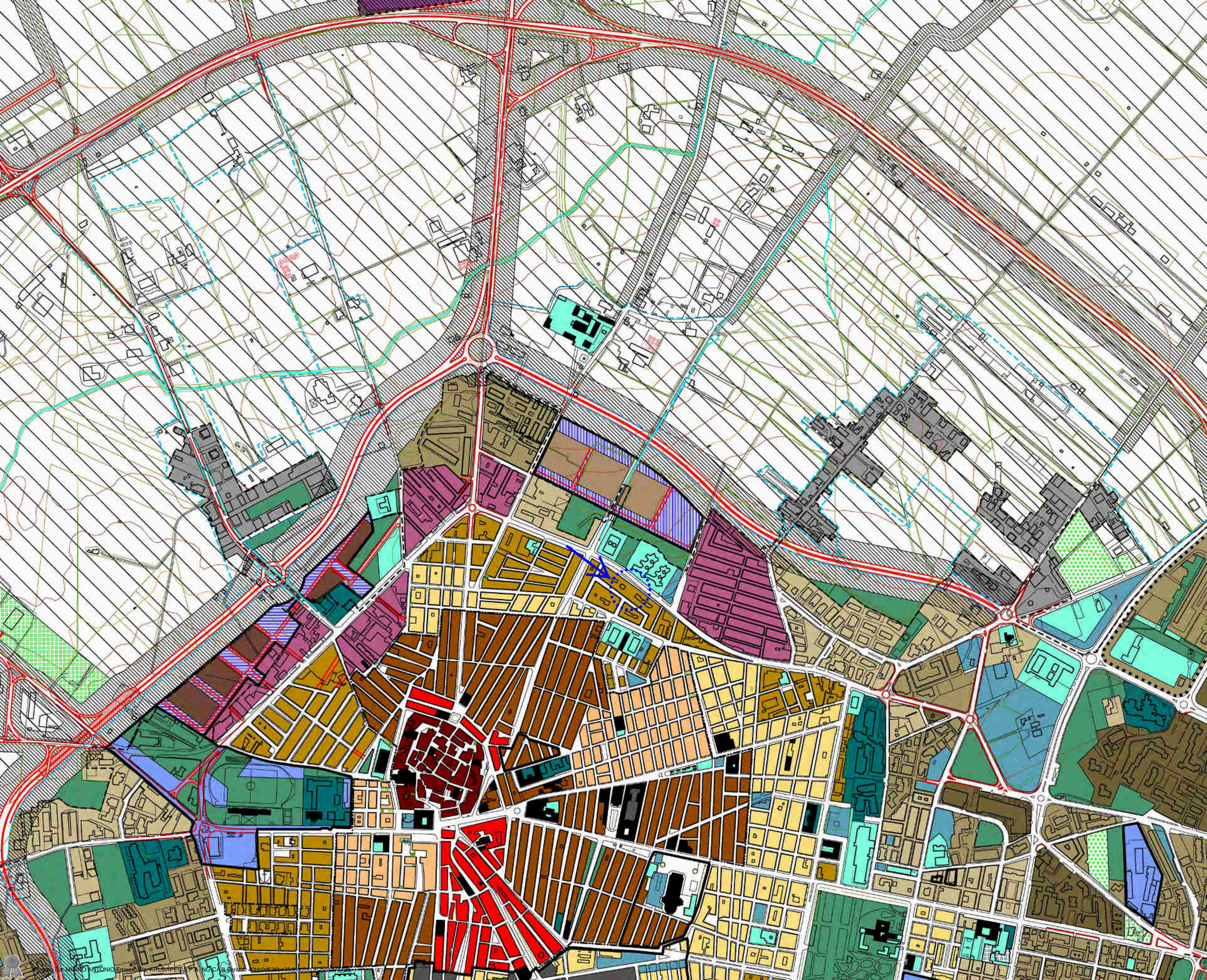



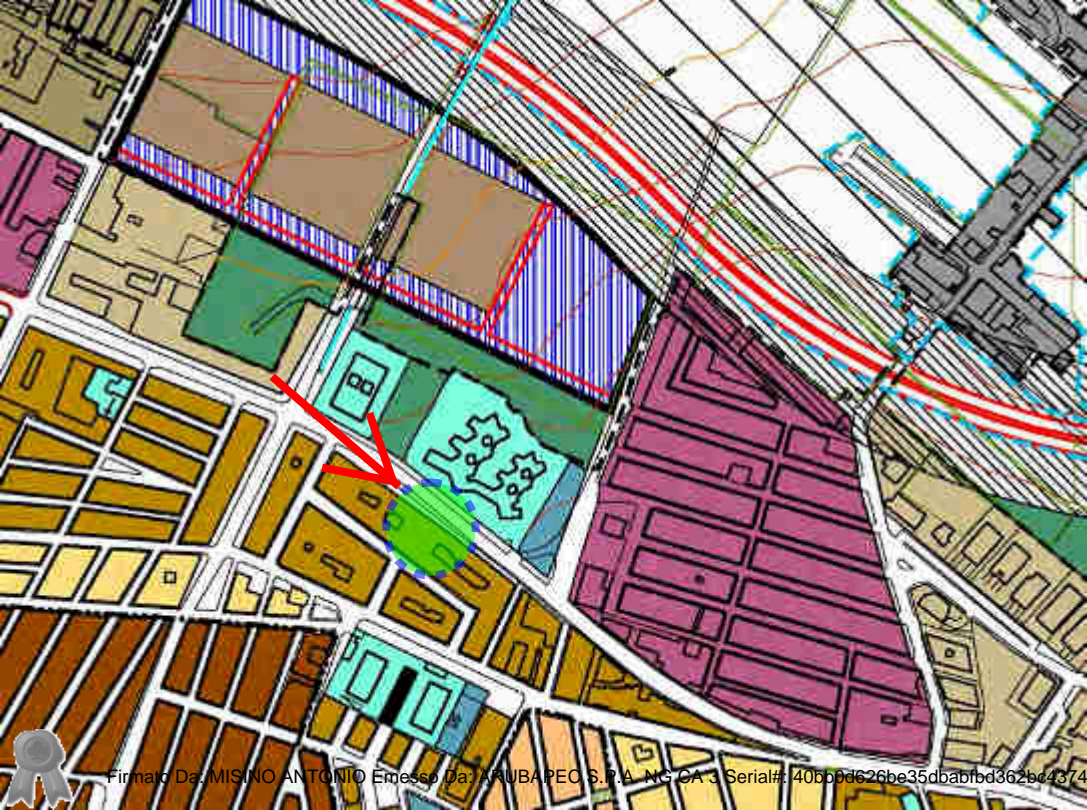





19-Apr-2019 19:23:19  
Prot. n. 7224951/2019

Scala originale 1:1000  
Dimensione cornice: 388.000 x 276.000 metri

Comune CERICIGNOLA  
Foglio 162 A11 A

N=100









Catasto

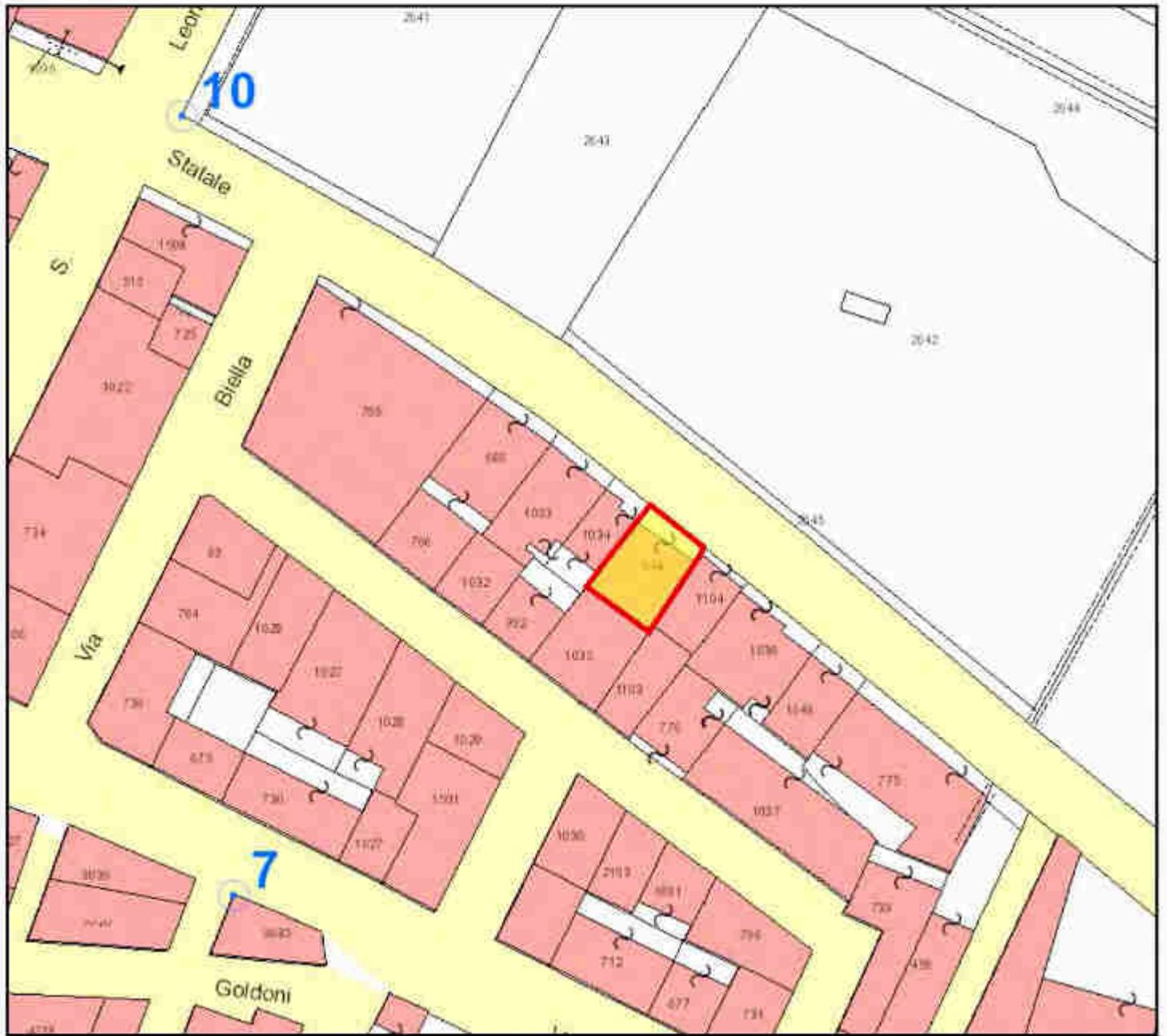

30m

1:1.000

Impossibile recuperare la mappa da [https://services.arcgisonline.com/arcgis/rest/services/World\\_Topo\\_Map/MapServer](https://services.arcgisonline.com/arcgis/rest/services/World_Topo_Map/MapServer)





Per visualizzare qui i Preferiti, seleziona quindi e trascina nella cartella della barra Preferiti. In alternativa, importali da un altro browser. [Importa Preferiti](#)



Map navigation toolbar including zoom in (+), zoom out (-), pan, and other navigation icons.



Viale Maria Santissima Ausiliatrice



Viale Maria Santissima Ausiliatrice, 82  
71042 Cerignola FG

- Indicazioni stradali
- Salva
- Nelle vicinanze
- Invia al telefono
- Condividi

- 7VCX+49 Cerignola, FG
- Aggiungi un luogo mancante
- Aggiungi la tua attività
- Aggiungi un'etichetta

Foto









**Pericolosità e Rischio**

**Peric. Idraulica**

 bassa (BP)

 alta (AP)

 media (MP)

**Cartografia di base**

