

TRIBUNALE ORDINARIO DI LATINA

(CANCELLERIA ESECUZIONI IMMOBILIARI)

ESECUZIONE IMMOBILIARE R.G.E. N. 235/2019

ALLEGATO 3

Latina, 14/01/2021

Il Consulente Tecnico di Ufficio

geom. Gianluca Donadio

A handwritten signature in black ink is written over a blue circular stamp. The stamp contains the text "GEOM. GIANLUCA DONADIO" and "CANTIERE" around the perimeter. The signature is a stylized, cursive script.

E=1:6800

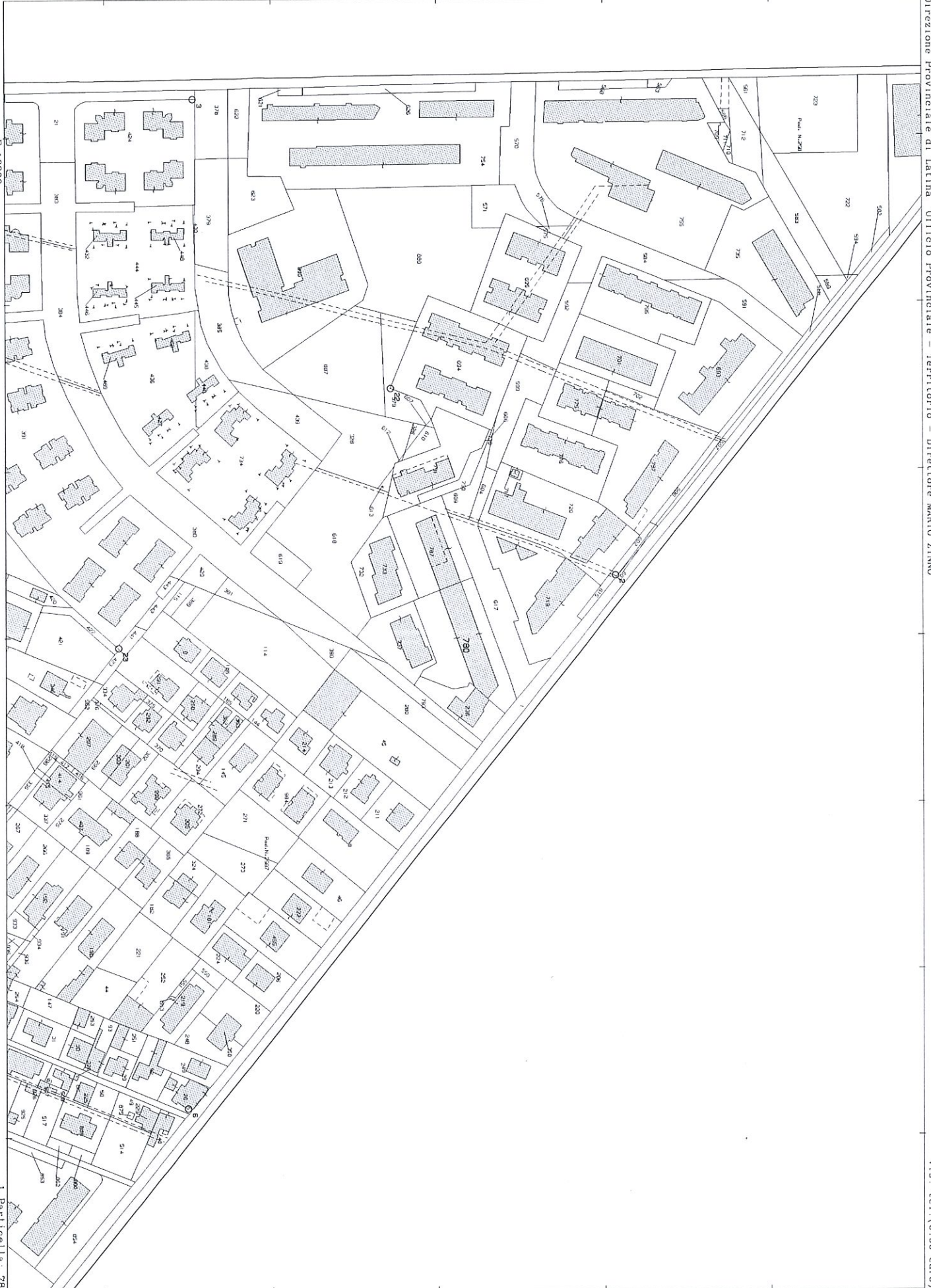

1 Particella: 760